

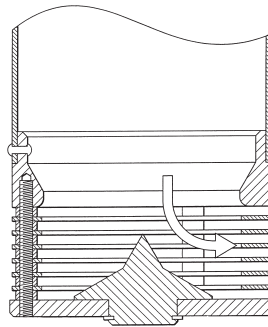

RIS-DIFFUSER-4

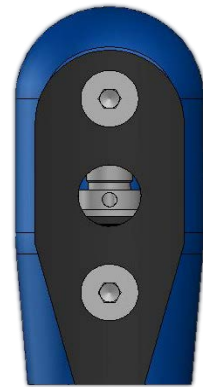

Diffuser cross-section showing laminar flow



Air Transfer Valve



With a plain drop tube



With a diffuser



With a Diffuser and ATV

**Function - provides horizontal laminar flow of fuel as it is discharged through the drop tube, when used in conjunction with an Air Transfer Valve exceptional reduction of disturbance and vapour growth can be achieved.**

- Reduces turbulence, aeration and waves in fuel in storage tanks
- Reduces vapour creation
- Reduces fuel contamination by directing flow away from debris on tank bottom
- Assembles to standard drop tube with rivets, installation template supplied
- Unrestricted flow path through vane stack
- When used with an Air Transfer Valve (ATV) substantial vapour savings can be achieved

**Materials:**

Anodised Aluminium  
Stainless Steel  
Brass

**Suitable for:**

Petroleum Spirit (including Ethanol Blends up to 90%)  
Diesel  
Bio Diesel / FAME Blends  
AvGas and Jetfuel

**Document Ref:**

DATA-CALM-FUEL-DELIVERIES-140901

**Installation Instructions:**

INS-RIS-DIFFUSER-3  
INS-RIS-DIFFUSER-4